

Max Operating Length 3.3
(66% Of Thread Length)

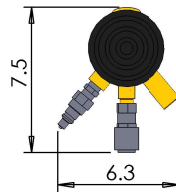
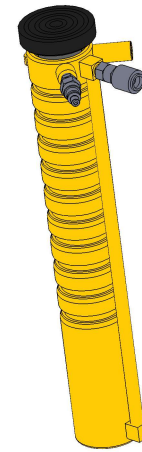
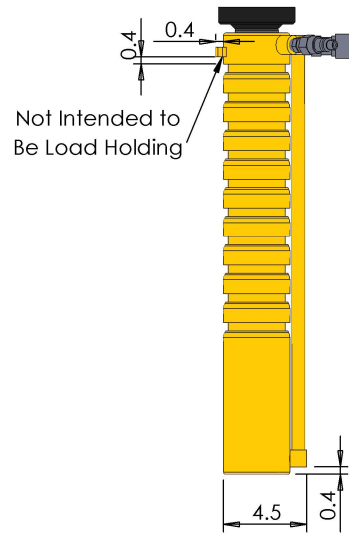
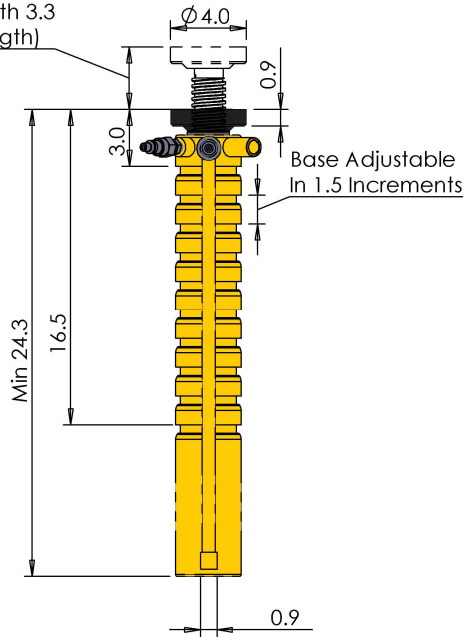

Capacity:30,000 LBS.
Unit Weight:65 LBS.
Bore:2.5"
Stroke:17"
Color:Yellow (Custom Colors Available)

PROPRIETARY AND CONFIDENTIAL

THE INFORMATION CONTAINED IN THIS DRAWING IS THE SOLE PROPERTY OF:

BUCKINGHAM STRUCTURAL MOVING EQUIPMENT, LLC.
BERNVILLE, PA. PHONE (610)488-8969

ANY REPRODUCTION IN PART OR AS A WHOLE WITHOUT THE WRITTEN PERMISSION OF BUCKINGHAM STRUCTURAL MOVING EQUIPMENT, LLC IS PROHIBITED.

DRAWN BY:

Darin Buckingham

DATE:

Wednesday, December 1, 2021 3:00:43 PM

BUCKINGHAM

DESCRIPTION:

15 Ton Double Acting 17" Stroke Crib Jack

SIZE
A

DWG. NO.
15CJDAAS0301D

REV
1

DO NOT SCALE DRAWING

SCALE: 1:10

SHEET 1 OF 1